

Technical Data Sheet.

Permacron® Speed Blender 1036

Permacron Speed Blender 1036 helps to achieve easy blending of Permasolid HS clearcoats and HS Automotive Top Coat 275.

- Is easy to apply.
- Achieves good wetting on all substrates.
- Leads to a very fine blending-in area where it meets the old paint.



For professional use only!

Spies Hecker simply closer.



An Axalta Coating Systems Brand

Permacron® Speed Blender 1036

Product preparation - application Standard - VOC



It is strongly recommended to use appropriate personal protection equipment during application to avoid respiratory, skin and eye irritation.

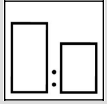

Can be used with:

2K Hardened Clearcoat	Permasolid HS
2K Hardened Topcoat	Permasolid HS Automotive 275

For recommended instructions see following pages.



Not applicable

VOC compliant

2004/42/IIB(e)(840) 750: The EU limit value for this product (product category: IIB(e)) in ready to use form is maximum 840 g/l of VOC. The VOC content of this product in ready to use form is maximum 750 g/l.

Permacron® Speed Blender 1036

Product preparation - application Spray can



It is strongly recommended to use appropriate personal protection equipment during application to avoid respiratory, skin and eye irritation.



Can be used with:

2K Hardened Clearcoat

Permasolid HS

2K Hardened Topcoat

Permasolid HS Automotive 275

For recommended instructions see following pages.

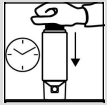

Not applicable

VOC compliant

2004/42/IIB(e)(840) 770: The EU limit value for this product (product category: IIB(e)) in ready to use form is maximum 840 g/l of VOC. The VOC content of this product in ready to use form is maximum 770 g/l.

Permacron® Speed Blender 1036

Blend-in method for Permasolid HS Clear Coats



Sanding the fade-out area and the transition to the original existing paintwork, e.g. with 3M Trizact P3000 Fine Finishing Disc or similar abrasives from other suppliers.

Optional: polish the fade-out zone with a coarse polish compound, if desired.

Clean the prepared area with Permahyd Silicone Remover 7080.

Mix any Permasolid HS Clear Coat according to the TDS. Overcoat the Permahyd Hi-Tec Base Coat 480 or Permahyd Base Coat 280/285 with ready-to-spray Permasolid HS Clear Coat. Fade-out the clear in staggered coats with reduced pressure within the sanded area.

Apply the pure Permacron Speed Blender 1036 in several thin coats with reduced pressure to the fade-out area. Dissolve the overspray and smooth the transition of the Permasolid HS Clear Coat and stay within the P3000 sanded area.

Optional: Stay within the polished area.

Dry according to the TDS of the respective clear.

Additional IR drying of the fade-out area may reduce the risk of the edge rolling back when polished.

If required, lightly sand the transition zone after drying and cooling depending on the finish to be achieved e.g. with 3M Trizact P3000 or similar.

Polish using a rotary polish machine. Make sure to control contact pressure and direction of rotation from the closed topcoat film to the fade-out area.

Permacron® Speed Blender 1036

Fade-out method for Permasolid HS Topcoat 257

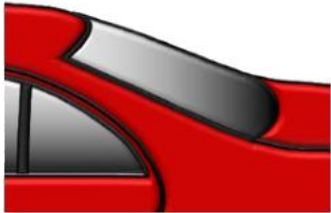

Sanding the fade-out area and the transition to the intact old paintwork, e.g. with 3M Trizact P3000 Fine Finishing Disc or similar abrasives from other suppliers.

Optional: polish the widest fade-out zone with a coarse polish compound, if desired.

Clean the prepared area with Permahyd Silicone Remover 7080.

Mix the Permasolid HS Automotive Top Coat 275 according to the TDS. Apply the ready-to-spray Permasolid HS Automotive Top Coat 275 to cover the repair area and fade-out in staggered coats with reduced pressure within the sanded fade-out area.

Apply the pure Permacron Speed Blender 1036 in several thin coats with reduced pressure to the fade-out area. Dissolve the overspray and smooth out the transition of the Permasolid HS Automotive Top Coat 275 and stay within the P3000 sanded area.

Optional: Stay within the polished area.

Dry according to the TDS of the Permasolid HS Automotive Top Coat 275.

Additional IR drying of the fade-out area may reduce the risk of the edge rolling back when polished.

If required, lightly sand the transition zone after drying and cooling depending on the finish to be achieved e.g. with 3M Trizact P3000 or similar.

Polish using a rotary polish machine. Make sure to control contact pressure and direction of rotation from the closed topcoat film to the fade-out area.

Permacron® Speed Blender 1036

Products



Permacron® Speed Blender 1036

Clean after use with a suitable solventbased guncleaner.

Remarks

- In Non-VOC countries Permacron Speed Blender 1036 can be mixed 1:1 with 2K Topcoat or 2K Clearcoat. The Fade-out process remains unchanged.
- Permacron Speed Blender 1036 can not be used with Permasolid HS Race Clearcoat 8700.

Consult Safety Data Sheet prior to use. Observe the precautionary notices displayed on the container.

All other products referred to in the refinish build up are from our Spies Hecker product range. System properties will not be valid when the related material is used in combination with any other materials or additives which are not part of our Spies Hecker product range, unless explicitly indicated otherwise.

For professional use only! The information provided in this documentation has been carefully selected and arranged by us. It is based upon our best knowledge on the subject at the date of issuance. The Information is given for information purposes only. We are not liable for its correctness, accuracy and completeness. It is up to the user to check the information with regard to up-to-dateness and suitability for his intended purpose. The intellectual property in this Information, including patents, trademarks and copyrights, is protected. All rights reserved. The relevant Material Safety Data Sheet and Warnings displayed on the product label need to be observed. We may modify and/ or discontinue operation of all or portions of this Information at any time in our sole discretion, without notice and assume no responsibility to update the Information. All rules set forth in this clause shall apply accordingly for any future changes and amendments.