



SATA® adam 2™ – precise pressure adjustment for perfect results

Flexibly Digitalised!

- Digital air micrometer to retrofit SATA paint spray guns – also available for SATAminijet
- Precise setting and display of the inlet pressure
- For perfect colour match precision
- New design which allows using one display on several paint spray guns
- Extended battery lifetime, the battery can be replaced by the end-user.
- Converts a non-digital paint spray gun to a "DIGITAL"



SATA adam 2 – keeping the pressure under control



The SATA adam 2 displays the spray gun inlet pressure with an accuracy of +/- 0.05 bar. The pressure can be **precisely adjusted** via the large regulation wings. All SATA paint spray guns can be retrofitted with the SATA adam 2. Thus, painters

**SATA adam 2 – additional
digital
air
micrometer**

can keep **the pressure always under control** to ensure precise **colour matching** and **high quality finishes**. Costly rework due to incorrect pressure setting is a thing of the past. The display always remains in the horizontal centre position ensuring **perfect readability** of the pressure at all times.



**SATAjet 3000 B with
SATA adam 2**

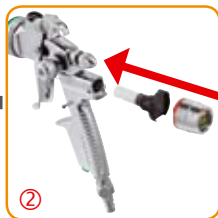

**SATAjet 3000 B:
insert the "dock"
and slide in the
"display"**



**Remove air
micrometer**



**SATAminijet: insert
the "mini dock" and
slide in the "dis-
play"**



**SATAminijet 3000 B
with SATA adam 2
mini**

New Design – High Flexibility

The SATA adam 2 consists of two separate components: The **SATA adam 2 dock** permanently replaces the air micrometer of the spray gun, allowing the precise adjustment of the inlet pressure. The second component, the **SATA adam 2 display**, is safely fitted to the "dock". It is equipped with high-precision measuring electronics and can be removed from the spray gun in no time at all; for example to use it on another spray gun with a premounted "dock". Thus, the SATA adam 2 is **a truly versatile piece of equipment**.

Furthermore, **investing in the digitalisation** of existing non-digital spray gun stock is becoming **far less costly**: The "dock" is separately available as an accessory part.

When cleaning the spray gun in a gun wash machine, the SATA adam 2 can stay on the spray gun; to extend its lifetime – beyond the warranty period –, the "display" should be removed **with one grip** and be cleaned by just using a cloth soaked with cleaning agent.

The only difference between the **SATA adam 2 mini** to equip SATAminijet spray guns and the SATA adam 2 for standard guns is in the design of the "dock". The displays themselves are identical and can be swapped between both "dock" versions.

Further advantages

The SATA adam 2 weighs just 49 g. Every painter will appreciate its **lightweight design**. The **user** himself can now **replace the battery** easily and quickly. Any imminent battery exchange will be indicated on the display. The lifetime is now up to 30 % higher than before to reduce the need for battery replacement to a minimum.

The SATA adam 2 is EX-proof and ATEX approved.

Article Numbers

Versions		Art. No.
SATA adam 2		160846
SATA adam 2 mini		160879
Spare parts / Accessories		Art. No.
SATA adam 2 display		160689
SATA adam 2 dock		160788
2 x SATA adam 2 dock		160796
SATA adam 2 mini dock		160861
SATA adam 2 battery kit		160739



SATA GmbH & Co. KG

Domertalstr. 20 • 70806 Kornwestheim • Germany
Tel.: +49 - 7154 - 811-200 • Fax: +49 - 7154 - 811-194
www.sata.com • E-mail: export@sata.com

Your SATA dealer: